

Explorer MAX

—Assembly Instruction



Product Name : Explorer Max
SKU : ROB0137
Company : DFRobot. Shanghai Zhiwei Robotics Corp. Ltd
Address : Rm 615,Bld. Y1,No.112 Liangxiu Rd,Pudong,Shanghai,China
Telephone : 86-21-61620183
Fax : 86-21-61001657
Email : service@dfrobot.com
Http : www.DFRobot.com



- ◎ The product uses battery of 4×1.5V AA.
- ◎ Designs and specifications are subject to change without notice.
- ◎ All final explanation rights within the scope prescribed by law belong to DFRobot.



- Please log in DFRobot official website : (www.dfrobot.com), searching ROB0137 in Product Wiki for more documents and tutorials to learn.

13 Quick Start Guide

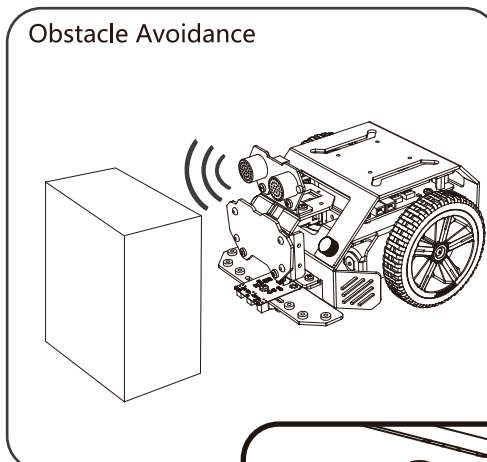

Mode 1

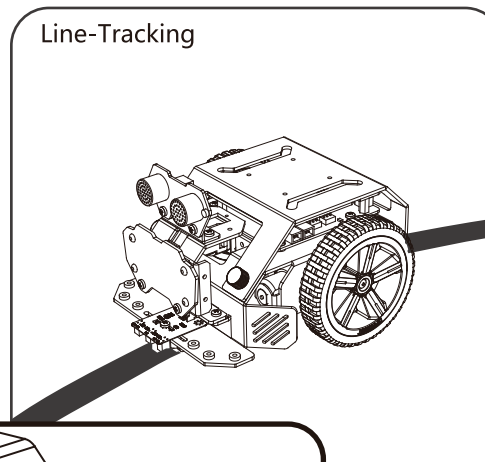

Mode 2

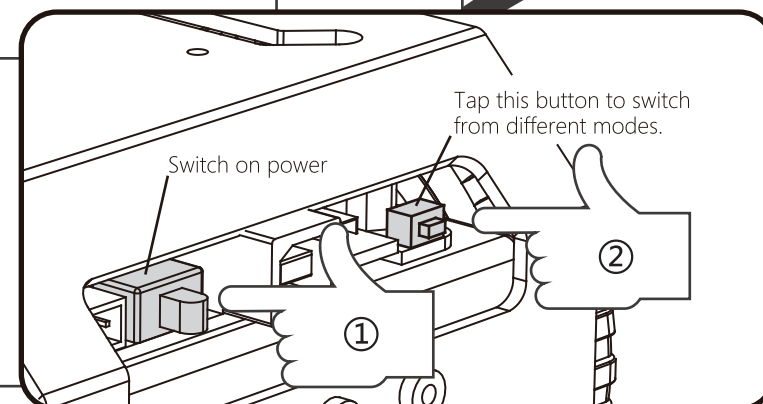

Mode 3

Mode 4

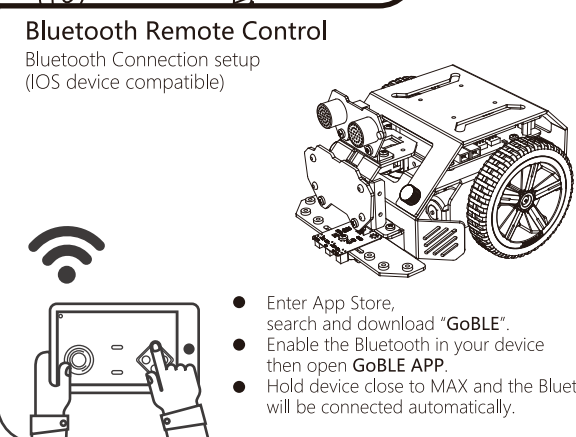
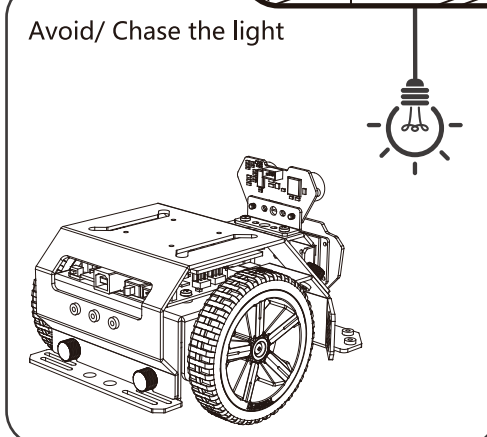

01 Motor Installation

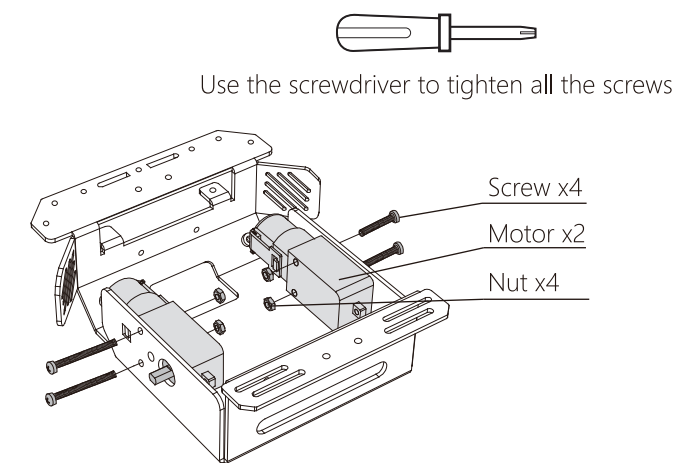

02 Wheel Installation

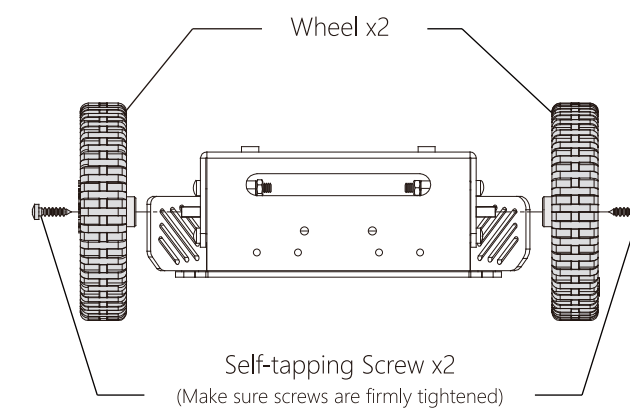

03 Roller wheel Installation

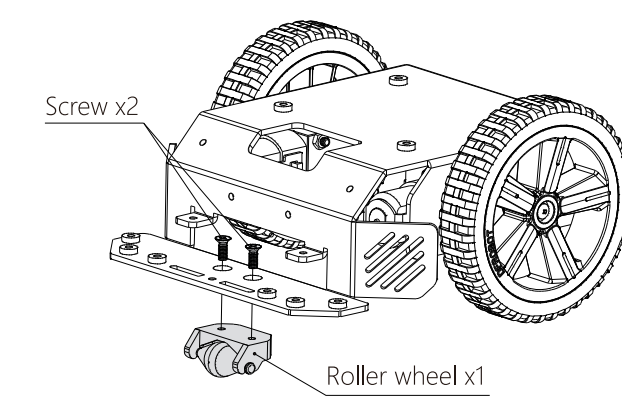

04 Line-tracking Sensor Installation

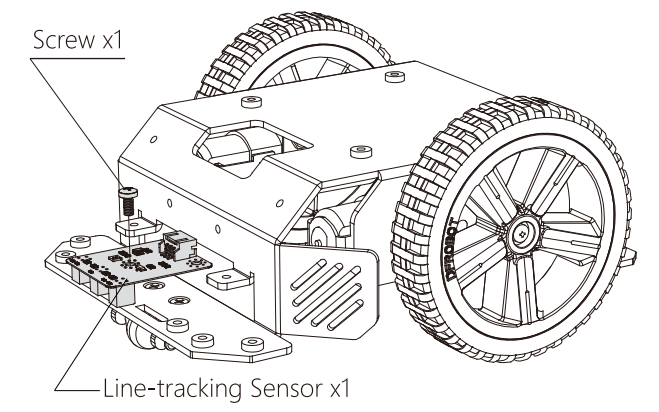

05 Main Board Installation

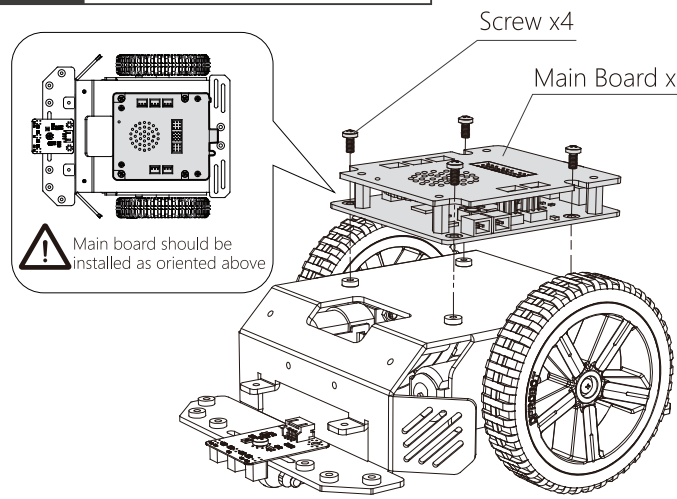

06 Multifunctional Mount Installation

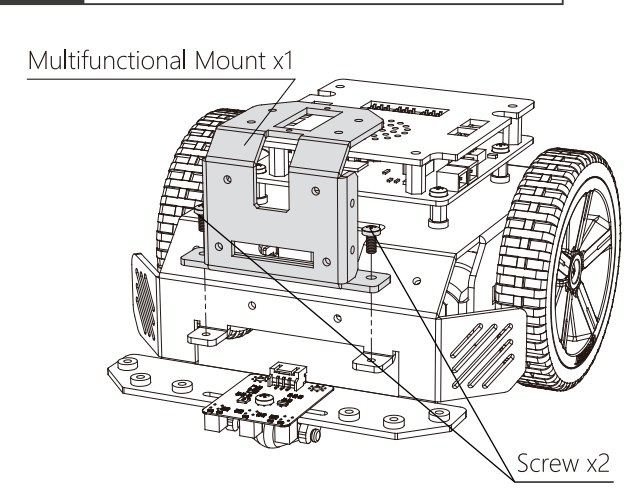

07 Ultrasonic Sensor Mount Installation

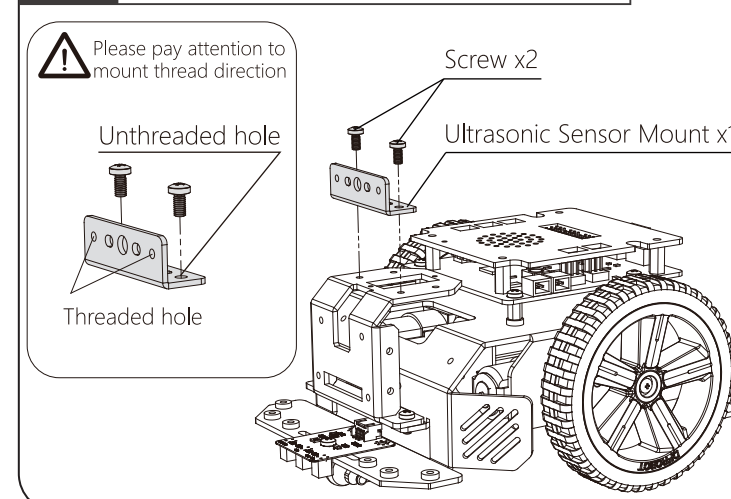

08 Ultrasonic & Light 2 in 1 Sensor Installation

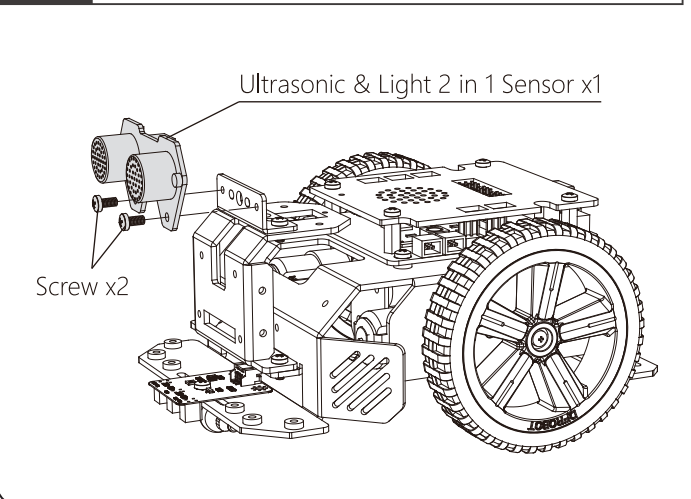

09 RGB LED Display Panel Installation

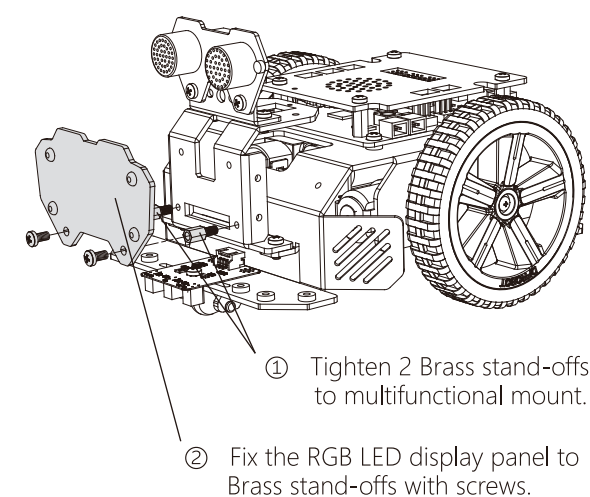

10 Electric Circuit Connection/Connection Diagram

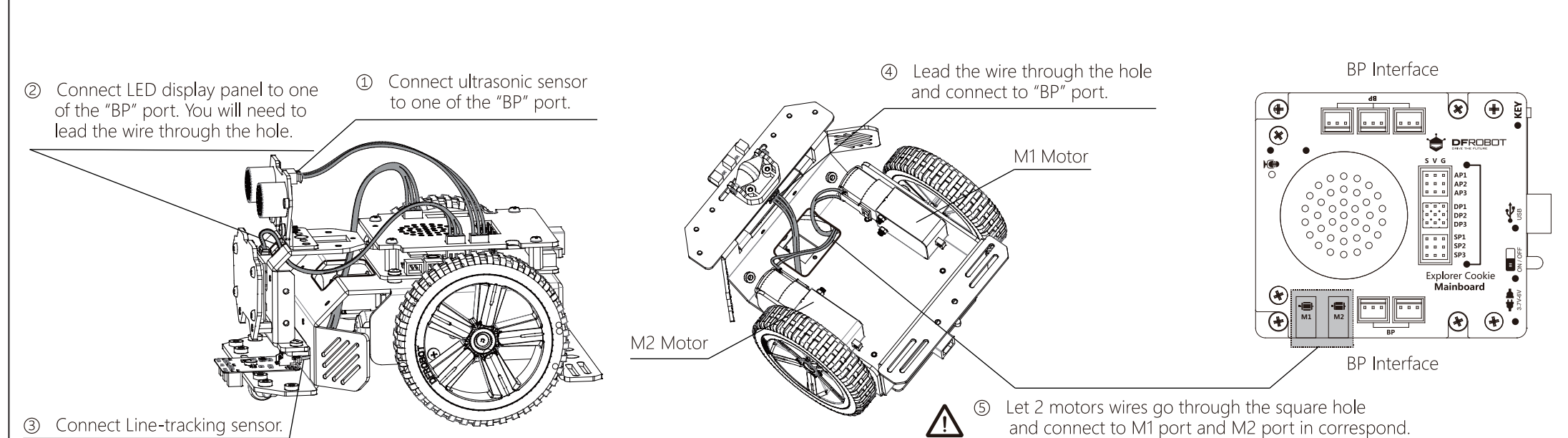

12 Top Cover Installation

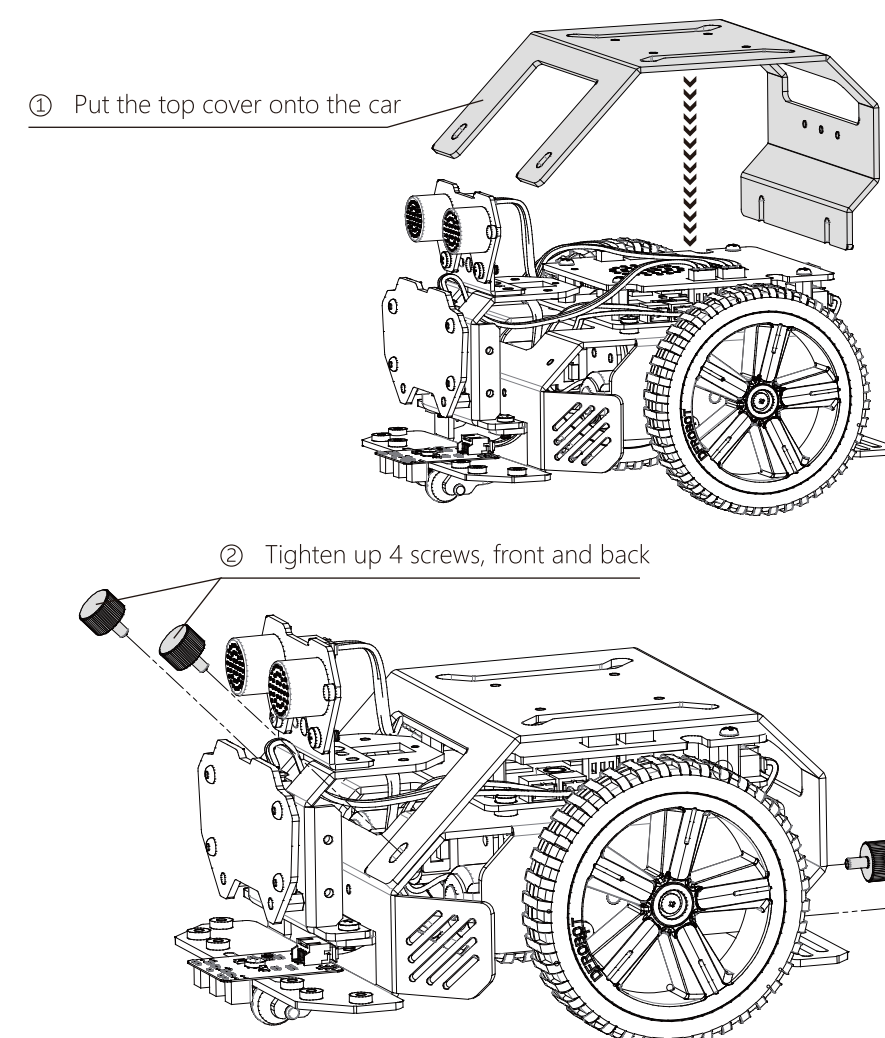

11 Battery Holder Installation

